

# TALKING MOUNTAIN

GROUP NAME: \_\_\_\_\_

EVENT DATES: \_\_\_\_\_

1080 Square Footage

70 Seated Capacity

9 Round Tables

9 6-Foot Tables

8 8-Foot Tables

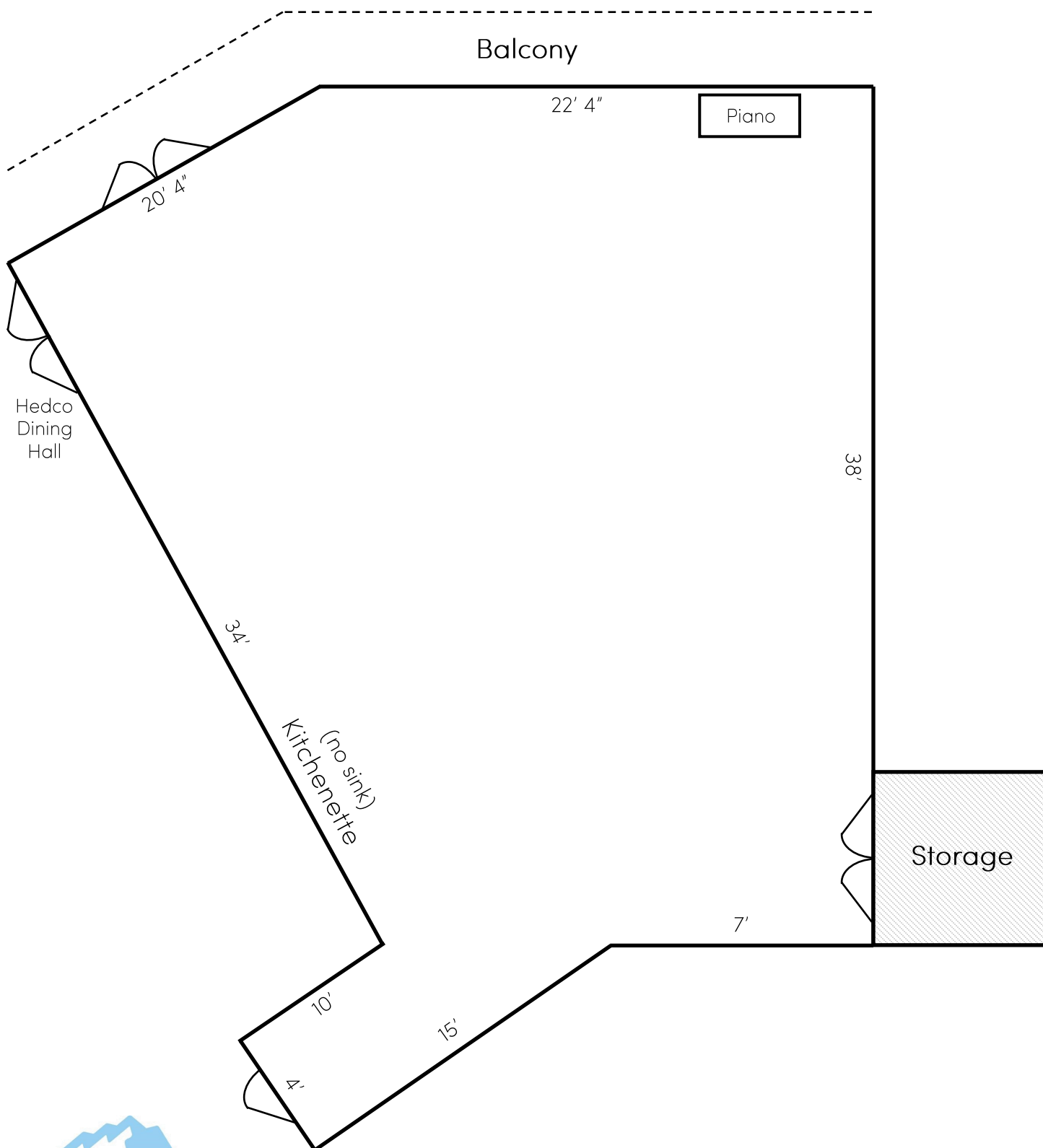

660 Hwy 50 (physical) | PO Box 289 (mailing)  
Zephyr Cove, NV 89448  
Office (775) 588-6759

Updated 7/31/23  
Diagram not to scale