

# LIVING WATERS

GROUP NAME: \_\_\_\_\_

EVENT DATES: \_\_\_\_\_

884 Square Footage

45 Seated Capacity

4 6-Foot Tables

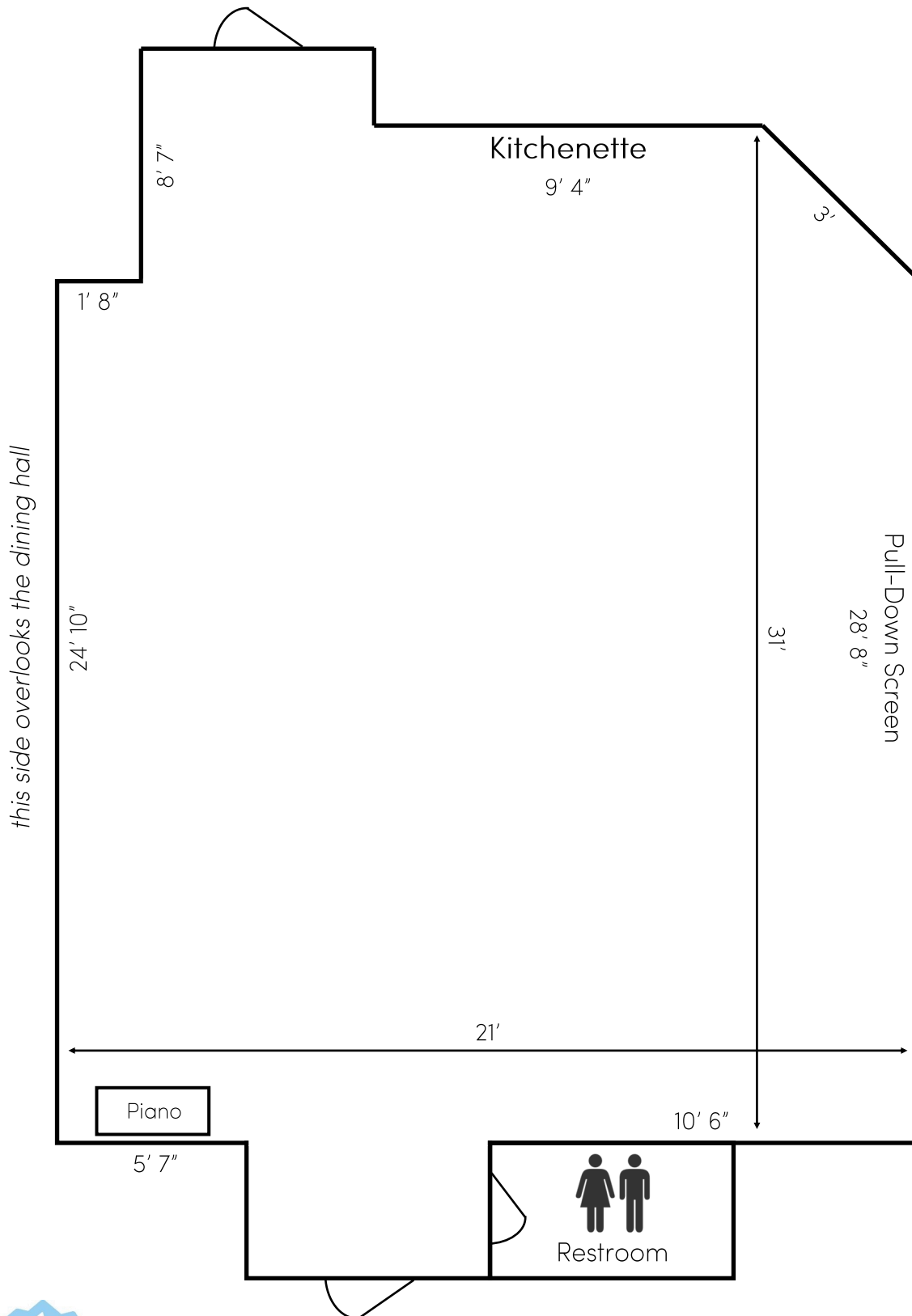

660 Hwy 50 (physical) | PO Box 289 (mailing)  
Zephyr Cove, NV 89448  
Office (775) 588-6759

Updated 8/6/23  
Diagram not to scale